

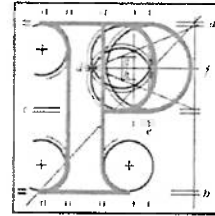

Our Case Number: ABP-317742-23

Planning Authority Reference Number:



**An
Bord
Pleanála**

Edmund Rice Schools Trust Limited
Meadow Vale
Clonkeen Road
Blackrock
Co. Dublin
AQ94 YN96

Date: 13 October 2023

Re: BusConnects Bray to City Centre Core Bus Corridor Scheme
Bray to Dublin City Centre.

Dear Sir / Madam,

An Bord Pleanála has received your recent submission in relation to the above-mentioned proposed road development and will take it into consideration in its determination of the matter. Please accept this letter as a receipt for the fee of €50 that you have paid.

Please note that the proposed road development shall not be carried out unless the Board has approved it or approved it with modifications.

The Board has also received an application for confirmation of a compulsory purchase order which relates to this proposed road development. The Board has absolute discretion to hold an oral hearing in respect of any application before it, in accordance with section 218 of the Planning and Development Act 2000, as amended. Accordingly, the Board will inform you in due course on this matter. The Board shall also make a decision on both applications at the same time.

If you have any queries in relation to this matter please contact the undersigned officer of the Board at laps@pleanala.ie

Please quote the above-mentioned An Bord Pleanála reference number in any correspondence or telephone contact with the Board.

Yours faithfully,

Eimear Reilly
Executive Officer
Direct Line: 01-8737184
HA02A

Tel	Tel	(01) 858 8100
Glaos Áitiúil	LoCall	1890 275 175
Facs	Fax	(01) 872 2684
Láithreán Gréasáin	Website	www.pleanala.ie
Ríomhphost	Email	bord@pleanala.ie

64 Sráid Maoilbhríde	64 Marlborough Street
Baile Átha Cliath 1	Dublin 1
D01 V902	D01 V902



Iontaobhas Scoileanna Éamainn Rís
Edmund Rice Schools Trust

Áras Éamainn Rís
Meadow Vale
Clonkeen Road
Blackrock
Co. Dublin
A94 YN96

AN BORD PLEANÁLA
LBG: 067611-23
ABP: 317742-23
10 OCT 2023
Fee: € Type:
Time: 12.42pm By: Hamer

www.erst.ie

9th October 2023

An Bord Pleanála
Strategic Infrastructure Division
64 Marlborough Street
Dublin 1
D01 V902

SUBMISSION TO PROPOSED COMPULSORY PURCHASE ORDER 2023
SCHEME: BRAY TO CITY CENTRE CORE BUS CORRIDOR SCHEME
APPLICANT: NATIONAL TRANSPORT AUTHORITY (BUS CONNECTS)
RELEVANT PLOT: 1008(1).2i
SUBMISSION FROM: EDMUND RICE SCHOOLS TRUST LIMITED

Dear Sir / Madam,

We, the Edmund Rice Schools Trust Limited, Meadow Vale, Clonkeen Road, Blackrock, Co. Dublin, A94YN96, make the following submission to the proposed Compulsory Purchase Order for the Bray to City Centre Core Bus Scheme (CPO Order 2023).

By letter dated 10th August 2023, we received notification of the proposed Compulsory Purchase Order in respect of a single plot of land identified as follows:

Address: Entrance to Colaiste Eoin & Colaiste Íosagáin, Stillorgan Road, Blackrock,
Co. Dublin
Reference: 1008(1).2i (Temporary) – Extends to 418.5 sq. m (0.04185 ha)



Iontaobhas Scoileanna Éamainn Rís
Edmund Rice Schools Trust

Áras Éamainn Rís
Meadow Vale
Clonkeen Road
Blackrock
Co. Dublin
A94 YN96

t
fC
e
www.erst.ie

The aerial photograph overleaf illustrates the approximate location and extent of the plot to be acquired on a temporary basis at Coláiste Eoin & Coláiste Íosagáin, Stillorgan Road. The plot in question extends along the entire ingress and egress of the Coláiste Eoin & Coláiste Íosagáin schools for a distance of approximately 37 meters. This area is utilised by Coláiste Eoin & Coláiste Íosagáin as the sole entry and exit points for pedestrians and vehicles.

It is proposed that this plot will be temporarily acquired as part of the Bray to City Centre core bus corridor scheme for the purpose of facilitating a dedicated bus corridor, along with all ancillary and consequential works associated therewith.

While the plot in question is relatively minor in scale at 418.5 sq. m, the temporary acquisition and the proposed scheme works most likely result in the disruption of the sole access to the schools, which in turn will have consequences for the day-to-day operations of Coláiste Eoin and Coláiste Íosagáin.



Iontaobhas Scoileanna Éamainn Rís
Edmund Rice Schools Trust

Áras Éamainn Rís
Meadow Vale
Clonkeen Road
Blackrock
Co. Dublin
A94 YN96



www.ersl.ie

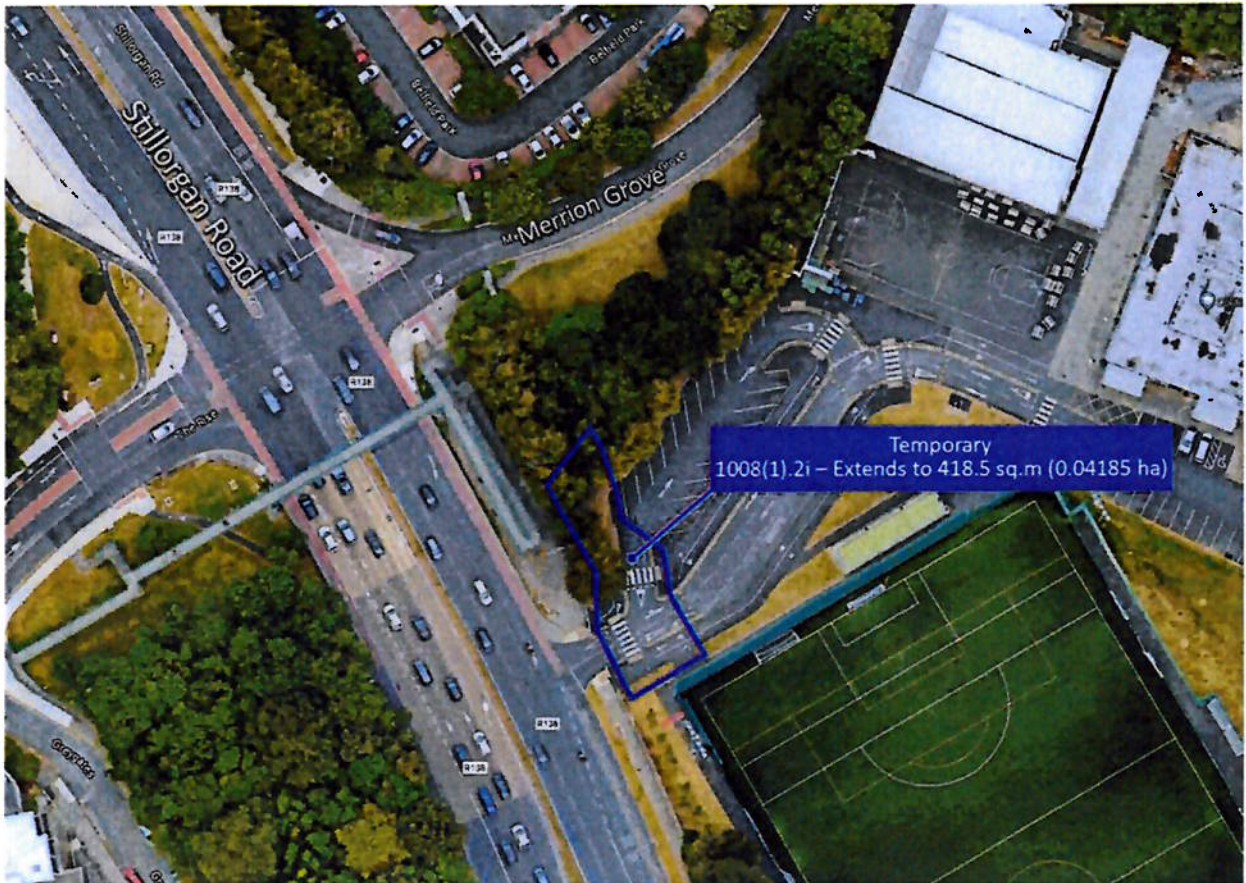



Iontaobhas Scoileanna Éamainn Rís
Edmund Rice Schools Trust

Áras Éamainn Rís
Meadow Vale
Clonkeen Road
Blackrock
Co. Dublin
A94 YN96

www.ersl.ie

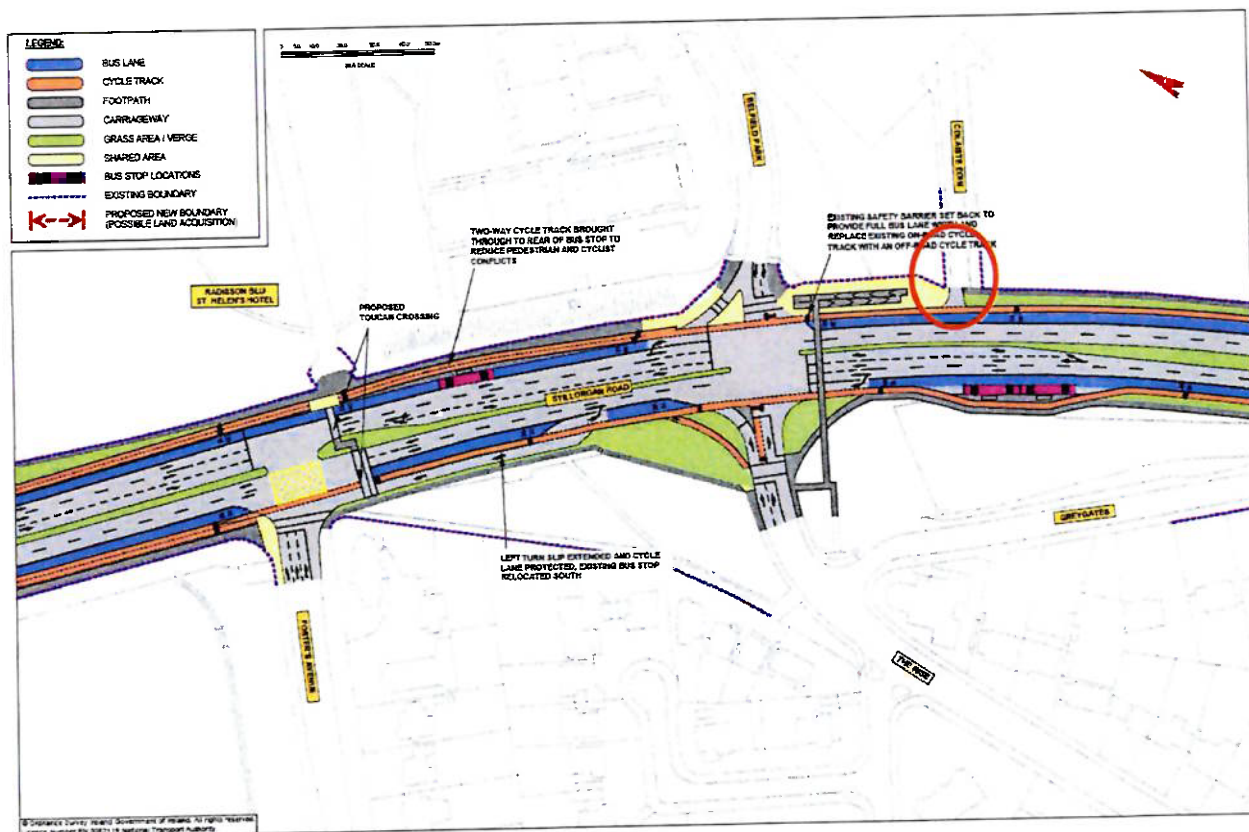

Proposed Scheme Layout – The entrance to Colaiste Eoin & Colaiste Íosagáin is approximately outlined in red

Brendan McCauley, Chairperson; Daniel McCarthy, Maedhbh Uí Chiagáin, Michael Walsh, Paul MacEntee, Ber O'Sullivan, John McCormack
Gerry Bennett, Chief Executive
Edmund Rice Schools Trust CLG. Reg 457269 / Charity no CHY18212



Iontaobhas Scoileanna Éamainn Rís
Edmund Rice Schools Trust

Áras Éamainn Rís
Meadow Vale
Clonkeen Road
Blackrock
Co. Dublin
A94 YN96



www.erst.ie

Given the scale of the two schools, any disruption to the access of the car park and pedestrian entrance/exit requires to be minimal so as to ensure the continuous and uninterrupted access and operation of the school and its amenities.

In respect of the temporary acquisition area the following clarifications are required:

- 1.) What is the proposed duration for the temporary land acquisition?
- 2.) Can we receive assurance that there will always be continuous and uninterrupted access/egress for to/from pedestrian and vehicular gates to the school?
- 3.) Will there be any trees removed as a result of the temporary land acquisition?
- 4.) That the all-weather pitch situated to the south-east of the temporarily acquired lands will remain unaffected in its entirety.
- 5.) That the car park will be uninterrupted, with no loss of spaces.



Front elevation subject property



Car parking behind entrance to subject property



Iontaobhas Scoileanna Éamainn Rís
Edmund Rice Schools Trust

Áras Éamainn Rís
Meadow Vale
Clonkeen Road
Blackrock
Co. Dublin
A94 YN96



www.erst.ie

Conclusion:

As highlighted above we have concerns regarding the temporary acquisition of the above listed lands at the entrance to Colaiste Eoin & Colaiste Íosagáin, Stillorgan Road.

While we welcome the proposal by the Acquiring Authority implementing Bus Connects, further detailed collaboration is required in order to ensure minimal disruption to the day-to-day operation of Colaiste Eoin & Colaiste Íosagáin.

We would gratefully request An Bord Pleanála to encourage the Acquiring Authority to actively engage with the Edmund Rice Schools Trust and The Board of Management of the two schools regarding the proposed timing and methodology of the works, in order to ensure a smooth process. Undertaking the scheme works with minimal temporary disruption to the operation of the schools is of upmost concern to the Edmund Rice Schools Trust.

We trust our concerns will be taken in consideration by An Bord Pleanála in the assessment of the proposed Compulsory Purchase Order for the Bray to City Centre Core Bus Scheme.

Please keep us informed of the progress in relation to the proposed Compulsory Purchase Order.

Yours sincerely,

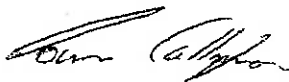

Louise Callaghan
Finance & Properties
The Edmund Rice Schools Trust